

Remove concrete along these lines. Clean reinforcement for either tied or welded laps of longitudinal and circumferential reinforcement.

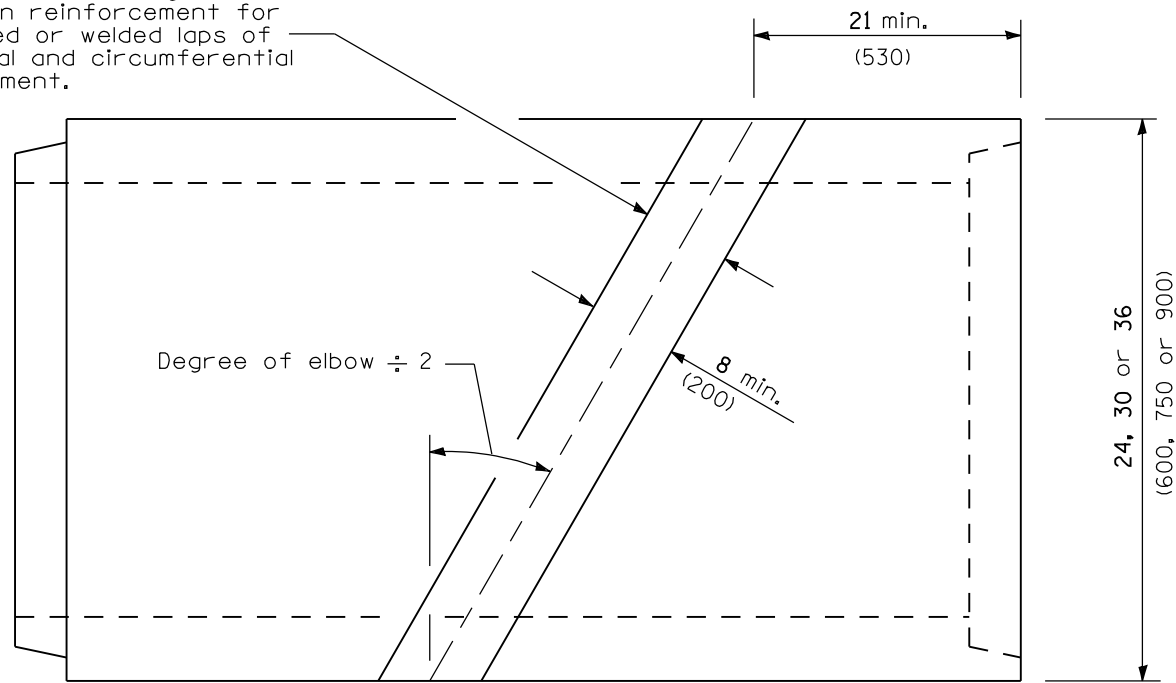

PLAN
(Reinforced concrete pipe)

1/2 (40) min., 2 1/2 (65) max. (Tied lap)
1/2 (40) min., 6 (150) max. (Welded lap)

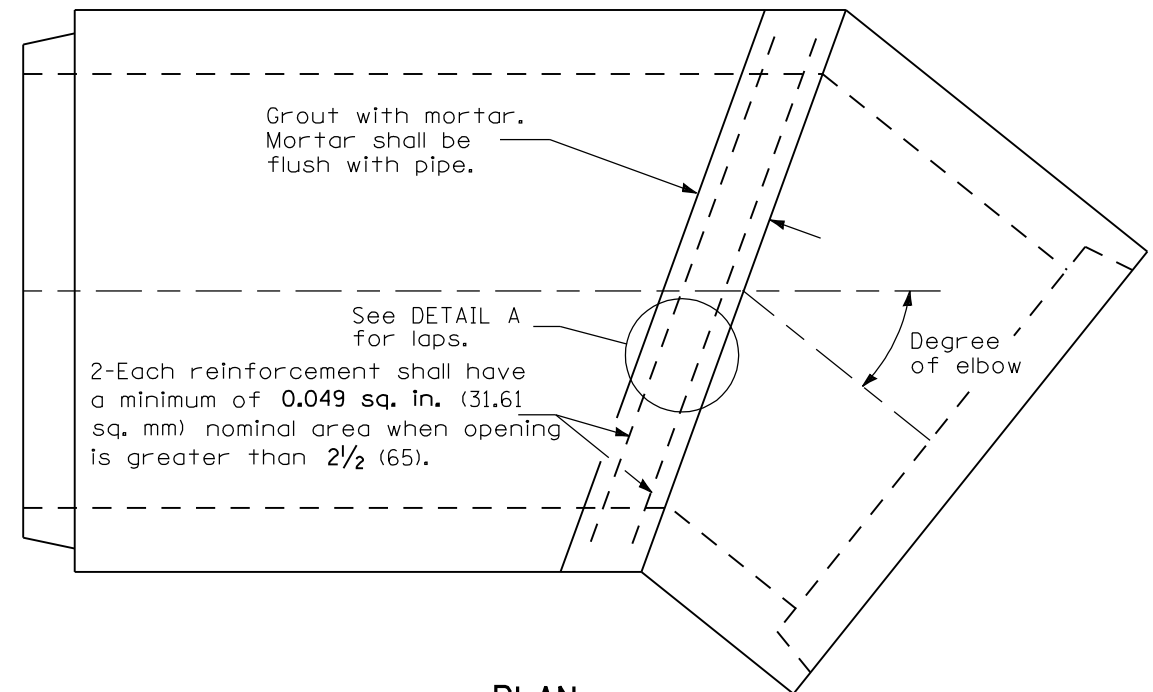

PLAN
(Reinforced concrete pipe elbow)

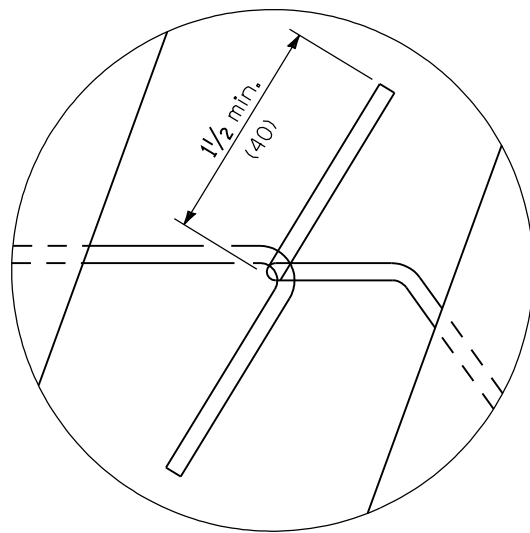

TIED LAP

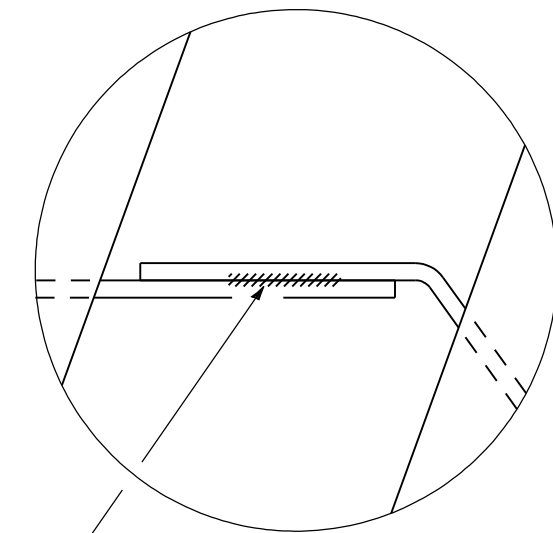

For wire dia. W14 - W6 (10.72 - 7.01),
length of weld shall be 3/4 (20) min.
For wire dia. W5.5 - W2.9 (6.73 - 4.88),
length of weld shall be 3/8 (10) min.
Other wire dia. shall be tied per detail.

1/8 (3)

WELDED LAP

DETAIL A

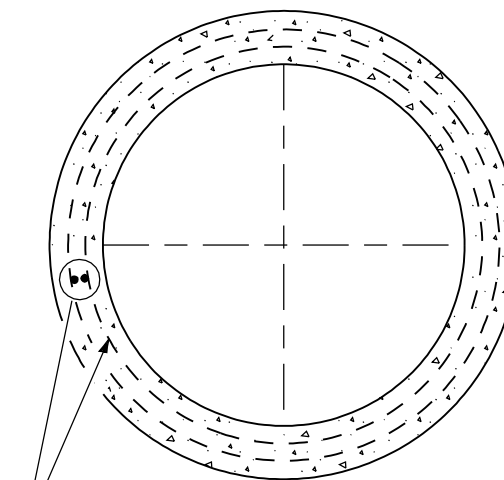

Standard reinforcement

TRANSVERSE SECTION

All dimensions are in inches (millimeters) unless otherwise shown.

DATE	REVISIONS
1-1-09	Revised reinforcement at elbow. Switched units to English (metric).
1-1-97	Renum. Standard 2262-6. Deleted DN Symbol.

REINFORCED CONCRETE PIPE ELBOW

STANDARD 542601-01

Illinois Department of Transportation

APPROVED January 1, 2009
Spatterson
ENGINEER OF POLICY AND PROCEDURES

APPROVED January 1, 2009
Ken E. Han
ENGINEER OF DESIGN AND ENVIRONMENT

ISSUED 1-1-97