

Doweled contraction joint  
(Placed in prolongation with pavement joints)  
construction option:

1. Form with 1/8 (3) thick steel template 2 (50) deep, and seal.
2. Saw at 4 to 24 hours, and seal.

Short radius curve  
(Such as entrances,  
side streets and  
ramp returns).

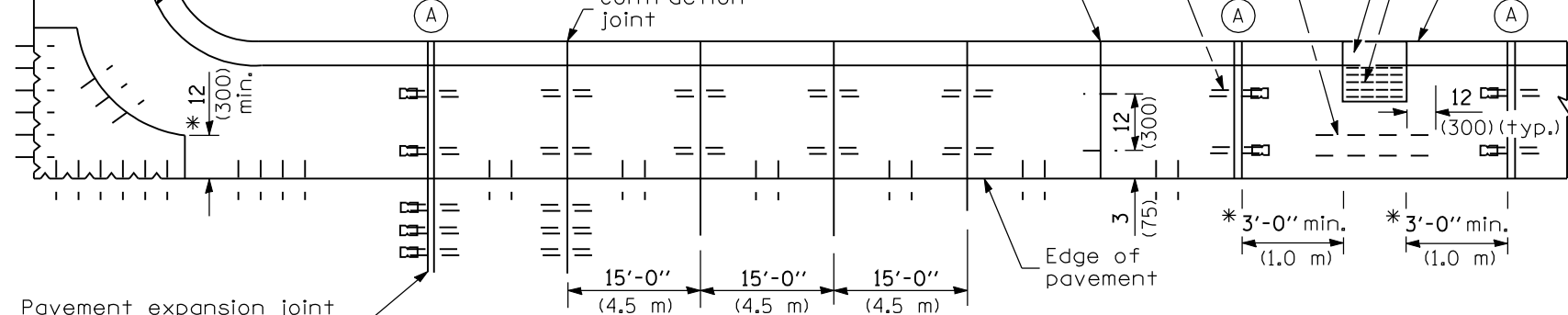

Pavement expansion joint  
with (or without) dowels

**PLAN**

**ADJACENT TO PCC PAVEMENT OR PCC BASE COURSE**

2-No. 4 (No. 13) bars  
with 2 (50) min. cl.  
2-No. 4 (No. 13) bars  
placed at mid-depth  
(when space permits)  
Drainage casting  
without curb box  
Back of curb

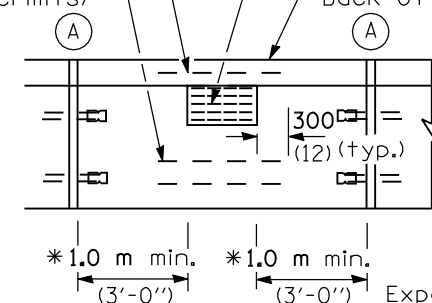

\* This dimension shall be  
adjusted to align with  
joint on the adjacent  
pavement

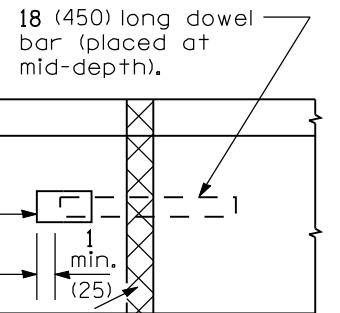

Full depth & width  
1 (25) - thick (min.)  
performed expansion  
joint filler.

**DETAIL A  
EXPANSION JOINT**

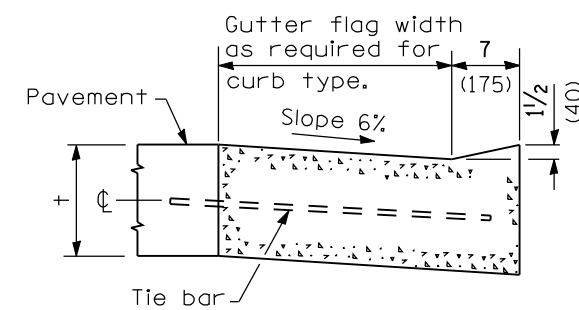

**DEPRESSED CURB (TYPICAL)**

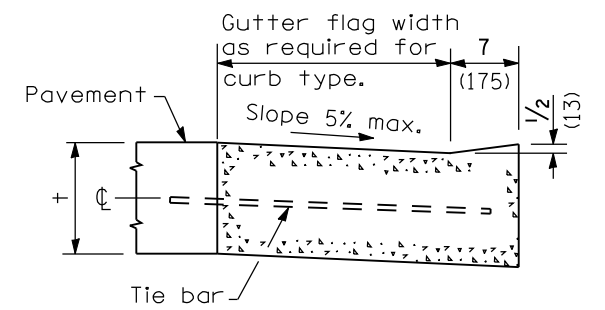

**DEPRESSED CURB ADJACENT  
TO CURB RAMP ACCESSIBLE  
TO THE DISABLED**

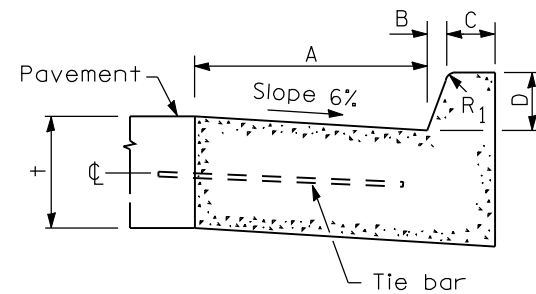

**BARRIER CURB**

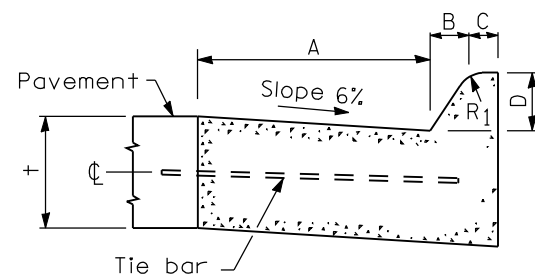

**MOUNTABLE CURB**

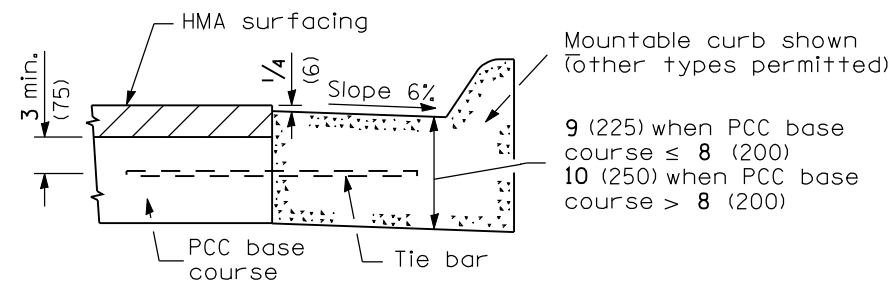

**ADJACENT TO PCC BASE COURSE  
WITH HMA SURFACING**

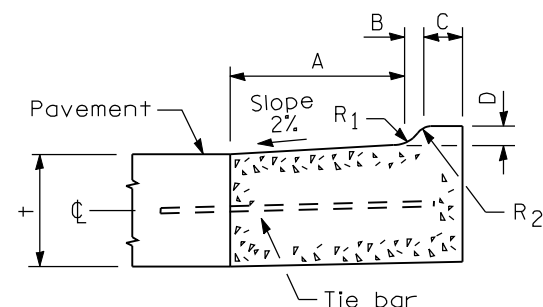

**M-2.06 (M-5.15) and M-2.12 (M-5.30)**

TABLE OF DIMENSIONS BARRIER CURB					
TYPE	A	B	C	D	R <sub>1</sub>
B-6.12 (B-15.3)	12 (300)	1 (25)	6 (150)	6 (150)	1 (25)
B-6.18 (B-15.45)	18 (450)	1 (25)	6 (150)	6 (150)	1 (25)
B-6.24 (B-15.60)	24 (600)	1 (25)	6 (150)	6 (150)	1 (25)
B-9.12 (B-22.30)	12 (300)	2 (50)	5 (125)	9 (225)	1 (25)
B-9.18 (B-22.45)	18 (450)	2 (50)	5 (125)	9 (225)	1 (25)
B-9.24 (B-22.60)	24 (600)	2 (50)	5 (125)	9 (225)	1 (25)

TABLE OF DIMENSIONS MOUNTABLE CURB						
TYPE	A	B	C	D	R <sub>1</sub>	R <sub>2</sub>
M-2.06 (M-5.15)	6 (150)	2 (50)	4 (100)	2 (50)	3 (75)	2 (50)
M-2.12 (M-5.30)	12 (300)	2 (50)	4 (100)	2 (50)	3 (75)	2 (50)
M-4.06 (M-10.15)	6 (150)	4 (100)	3 (75)	4 (100)	3 (75)	NA
M-4.12 (M-10.30)	12 (300)	4 (100)	3 (75)	4 (100)	3 (75)	NA
M-4.18 (M-10.45)	18 (450)	4 (100)	3 (75)	4 (100)	3 (75)	NA
M-4.24 (M-10.60)	24 (600)	4 (100)	3 (75)	4 (100)	3 (75)	NA
M-6.06 (M-15.15)	6 (150)	6 (150)	2 (50)	6 (150)	2 (50)	NA
M-6.12 (M-15.30)	12 (300)	6 (150)	2 (50)	6 (150)	2 (50)	NA
M-6.18 (M-15.45)	18 (450)	6 (150)	2 (50)	6 (150)	2 (50)	NA
M-6.24 (M-15.60)	24 (600)	6 (150)	2 (50)	6 (150)	2 (50)	NA

**GENERAL NOTES**

The bottom slope of combination curb and gutter constructed adjacent to pcc pavement shall be the same slope as the subbase or 6% when subbase is omitted.

t = Thickness of pavement.

Longitudinal joint tie bars shall be No. 6 (No. 19) at 24 (600) centers in accordance with details for longitudinal construction joint shown on Standard 420001.

A minimum clearance of 2 (50) between the end of the tie bar and the back of the curb shall be maintained.

All dimensions are in inches (millimeters) unless otherwise shown.

DATE	REVISIONS
1-1-09	Switched units to English (metric).
1-1-07	Switched to Hot-Mix Asphalt (HMA) terminology.

**CONCRETE CURB TYPE B  
AND COMBINATION  
CONCRETE CURB AND GUTTER**  
(Sheet 1 of 2)  
**STANDARD 606001-04**

Illinois Department of Transportation  
PASSED January 1, 2009  
ENGINEER OF POLICY AND PROCEDURES  
APPROVED January 1, 2009  
ENGINEER OF DESIGN AND ENVIRONMENT

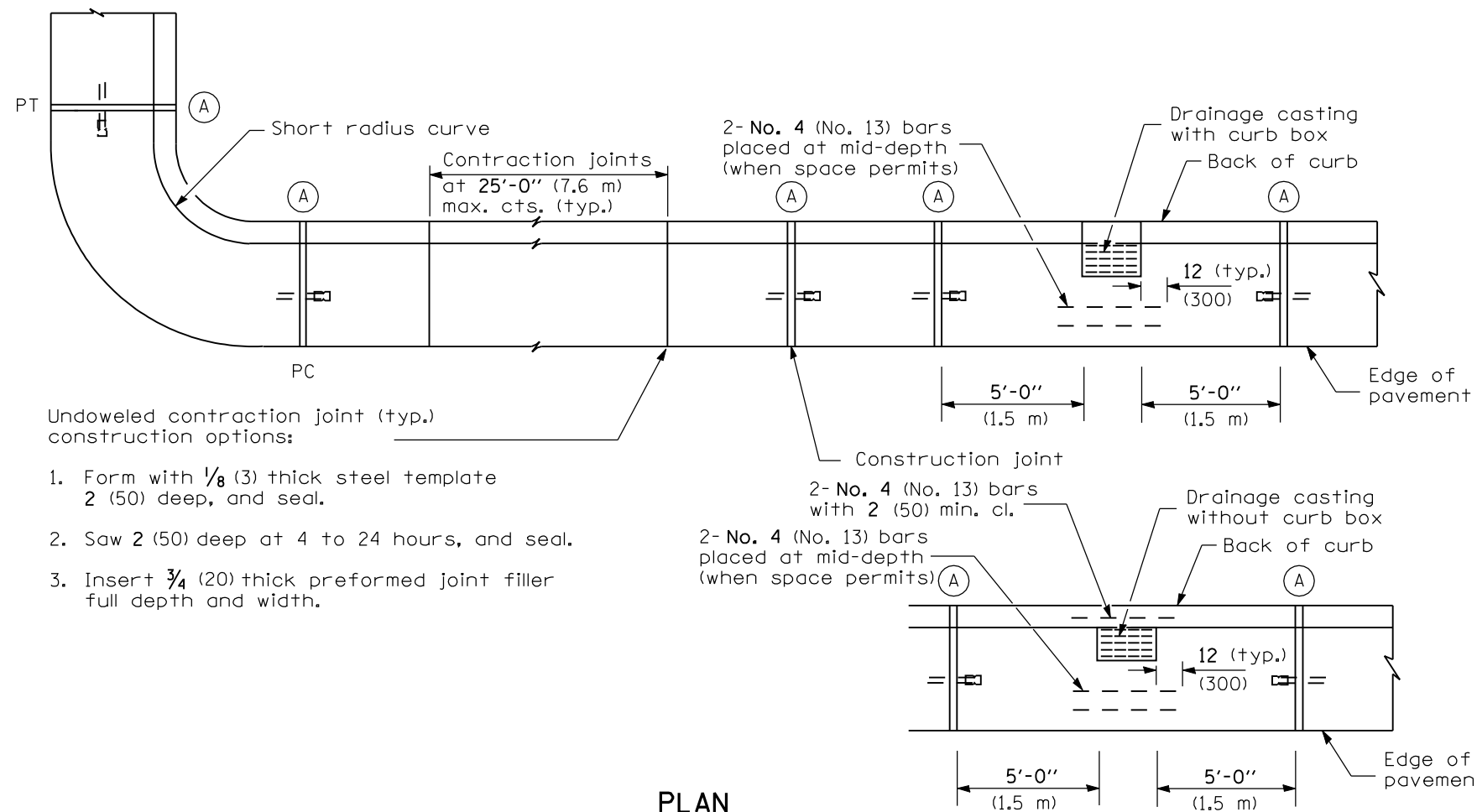

Undoweled contraction joint (typ.) construction options:

1. Form with  $\frac{1}{8}$  (3) thick steel template 2 (50) deep, and seal.
2. Saw 2 (50) deep at 4 to 24 hours, and seal.
3. Insert  $\frac{3}{4}$  (20) thick preformed joint filler full depth and width.

**PLAN**

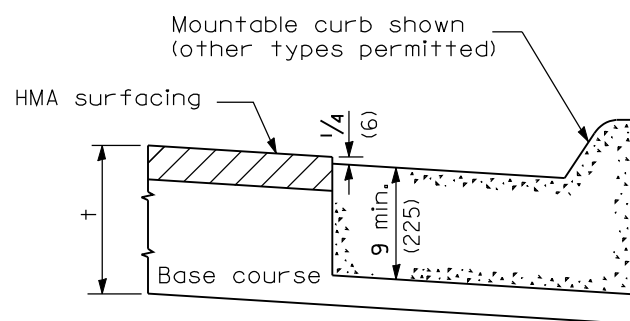

ON DISTURBED SUBGRADE

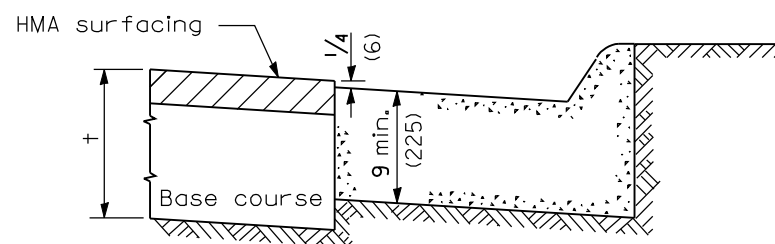

ON UNDISTURBED SUBGRADE

ADJACENT TO FLEXIBLE PAVEMENT

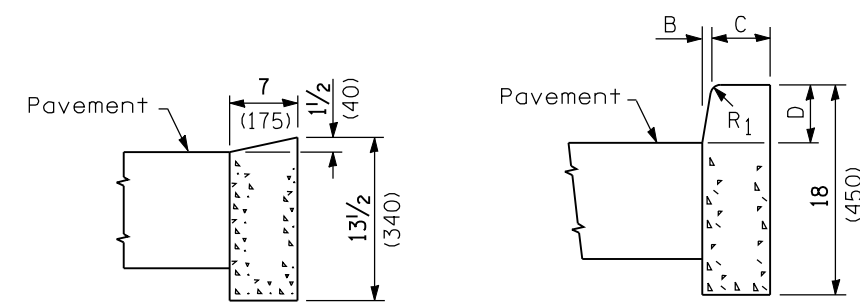

DEPRESSED CURB

BARRIER CURB

ADJACENT TO FLEXIBLE PAVEMENT

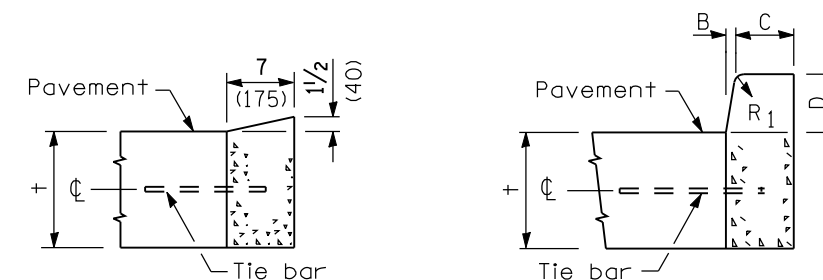

DEPRESSED CURB

BARRIER CURB

ADJACENT TO PCC PAVEMENT OR PCC BASE COURSE

CONCRETE CURB TYPE B